King's Lynn Multi User Community Hub

KLYRP Steering Group - 13 Dec 2022

Hannah Edge
Programme Manager

Hannah.edge@norfolk.gov.uk

Verity Bennett
Project Manager

Verity.bennett2@norfolk.gov.uk

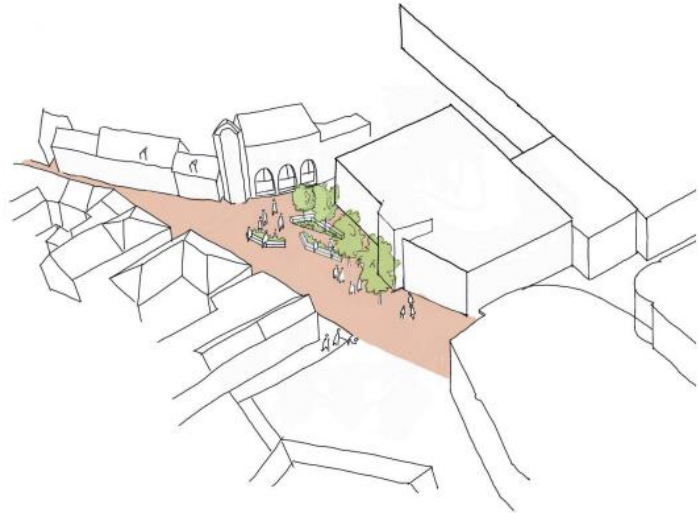

Vision

We are creating a new, modern, accessible library, learning, and community hub in the heart of King's Lynn town centre

Our vision for the Hub is to create a place where residents can access a range of public services they value, alongside information and advice they trust, with library and learning at their heart. A welcoming, safe space where a range of partners offer support and people can connect, learn, be inspired and find the resources they need to thrive.



Overview

- Bringing Libraries, Adult Learning and other stakeholders and partners together, in the town centre
- Delivering the right skills, services and support to residents in the town to improve outcomes and drive prosperity
- Increasing footfall and diversity of the Town Centre Offer
- Creating Cohesion with wider Town Deal programmes for King's Lynn



King's Lynn Multi User Community Hub

Objectives

- Develop a co-located community multi-use hub facility in the town centre of King's Lynn
- Improve the perception of the town centre to attract more visitors
- Develop new community partnerships to provide a variety of programming and community support offers from the hub
- Provide skills and educational opportunities for residents starting at entry level
- Provide services and facilities for start-ups and businesses

Inputs

Stakeholder Engagement



Business Case Development



£7.4m Towns Fund Funding



£3m funding plus £2m underwritten risk from NCC



Impacts

- Transformed landscape of town centre with aspirational building and associated public realm
- More people attracted to town centre
- New community partnerships forged
- Skills progression for the workforce - encouraging lifelong professional development, upskilling and reskilling
- Supporting businesses to be more productive, innovative and grow

Indicative design

INTERNAL SKETCH VIEW

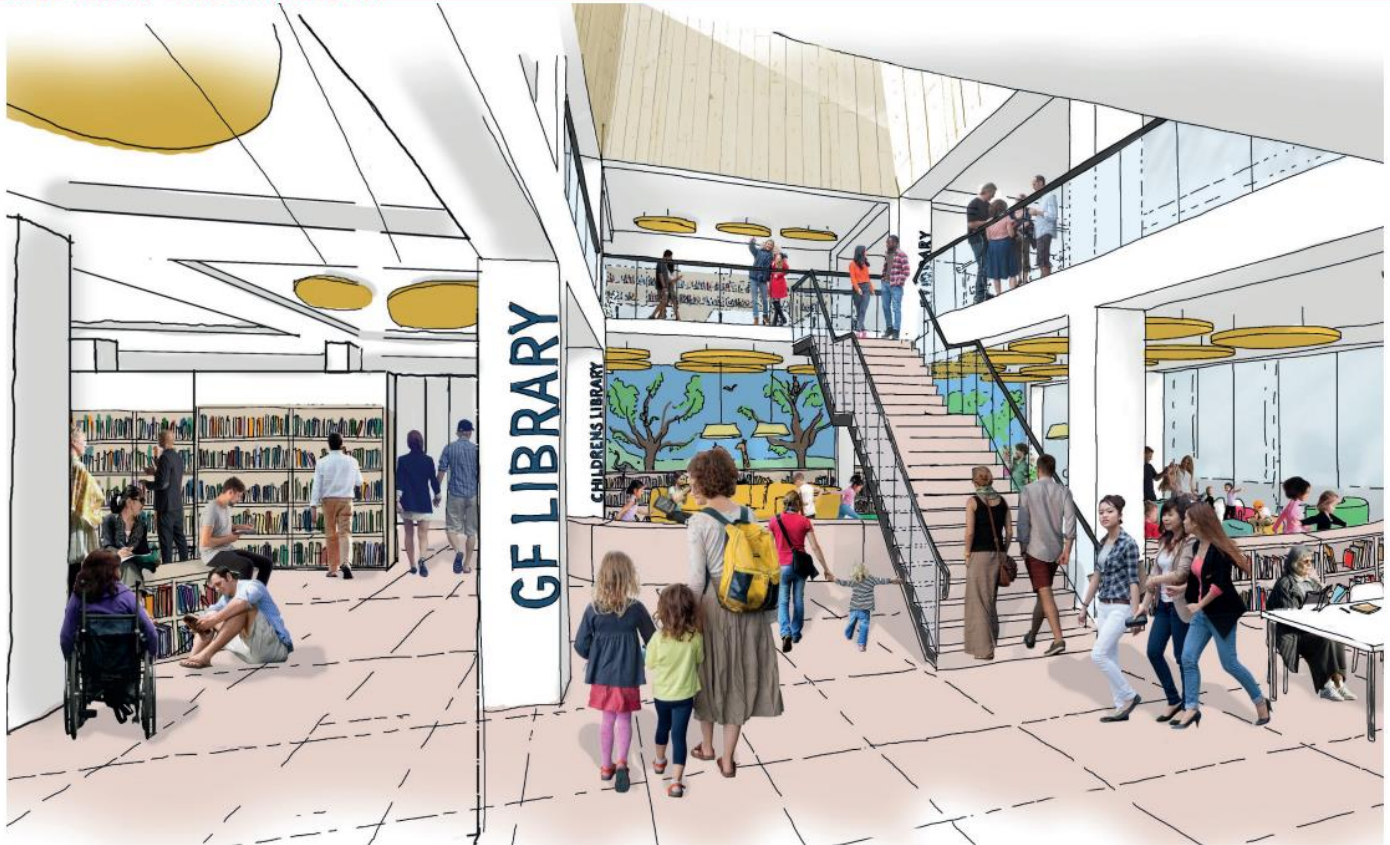

01 Welcome & Arrival

A warm, welcoming double height arrival and exhibition space - the shop front of the Community Hub.

02 Children's Library

An active and engaging, secure children's library located close to the entrance and arrival space.

Young Persons Library

An active and engaging, young persons library located close to the entrance and arrival space.

04 Reference Rare

Safe storage of significant rare reference material with adjacent reading room.

05 Open Library

Open library space with flexible, shared space for open collections, readers and activity spaces.

06 Cafe

A welcoming, convenient pop up cafe offer with seating throughout the library.

07 Staff Workroom & Deliveries

A staff workroom to process and sort collections, co-located with goods lift and delivery bay.



A Modern Library...

Is co-designed by residents and partners

Access to formal qualifications

Core skills learning programmes

Vocational learning

Community Learning

Public PC space – and digital support

Performance & Exhibition Space

Drop in / Learning zones

Book space – reading and activity areas

Provides residents with

Creative arts and other personal interest courses

BIPC

Employability programmes

Consultation /121 rooms

Children's and early years activities

Business skills

Training & Community rooms

Family learning

Is co-delivered by many organisations

Wellbeing programmes

Teenage groups

Provides services driven by needs and demand

Progress to date

- Investigations into project began in 2019
- Town Deal approval and support 2021
- RIBA 1 completed July 2022
- Property identified and purchase underway
- Business case developed and submitted (Sep 22)
- Project approved by DLUHC and TD funding secured (Nov 22)



Next Steps – King’s Lynn Multi User Community Hub

- Appoint Project and Cost Managers (Construction)
- Commence RIBA Design Stage 2 (Late spring 2023)
- Branding
- Audience development plan
- Skills programme development
 - TD project join up – *what is the journey for learners?*
- Operating model and governance
- **Delivery date: September 2025**

Collaboration opportunities – KLYRP Steering group

- Provide the facilities, learning offer and support structures for learning and skills with Adult Learning, Libraries together with wider stakeholders and VCSE support in one easy to access location
- Support the aims of the **youth retraining pledge** with a place to learn, meet and grow in the town centre;
- Flexible, bookable spaces for 121's, larger community groups as well as study spaces, drop in desks and an increased Public PC offer

Collaborative planning
for a core provision
Digital skills / ESOL /
functional skills

Branding
Develop shared materials
that communicate to
learners based on what
they say they need

IAG
Shared resourcing of
information and advice
to provide impartial
advice and support to
learners, on demand

Engagement
Shaping the space
Understand what
learners and employers
want and their barriers
to access

Progression
Plan course progression
pathways based on
employer and labour
market needs

Shared funding bids for
maximum impact
Shared prosperity /
levelling up and other
national skills grants



ANY QUESTIONS